

Simple, robust magnetic ballast

HID-Basic Semi-Parallel ballasts for SON/CDM/MH lamps

The HID Basic Semi-Parallel ballast is an impregnated (HID standard) electromagnetic copper/iron ballast for use with an external ignitor for HID lamps.

Benefits

- Limited volume of ballast coil; also lightweight
- Simple installation and cabling

Features

- Orthocyclic winding process
- Ballasts equipped with screw terminal blocks as standard
- Earthing-while-mounting facility (HID Standard ballasts)
- Low watt losses

Application

- For use with SON and HPI (PLUS) lamps in road, public, area and industry lighting
- For use with MHN/CDM lamps in shop, lobby and city beautification applications
- HID-Basic ballasts should be restricted to built-in situations where relative humidity is limited.

HID-Basic Semi-Parallel ballasts for SON/CDM/MH lamps

Versions

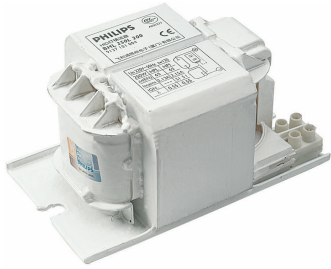

GPPR BCSON

Dimensional drawing

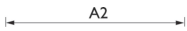

Product	D1	C1	A1	A2	B1
BSN 250L 302I	6.3 mm	64.5 mm	150.0 mm	129.0 mm	72.5 mm
BSN 70L 300I TS	6.2 mm	51.5 mm	117.0 mm	110 mm	57.1 mm

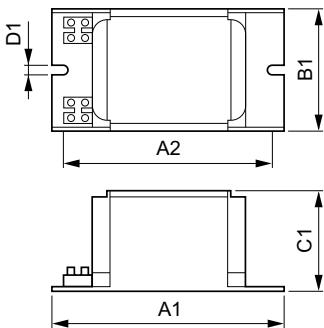

Product	D1	C1	A1	A2	B1
BSNE 250L 300I TS	6.3 mm	64.5 mm	165.0 mm	144 mm	75.0 mm
BSNE 400L 300I TS	6.3 mm	82 mm	165.0 mm	144 mm	96.0 mm



HID-Basic Semi-Parallel ballasts for SON/CDM/MH lamps

Operating and Electrical

Input Frequency 50 Hz

Operating and Electrical

Order Code	Full Product Name	Input Voltage	Order Code	Full Product Name	Input Voltage
913710102850	BSN 250L 302I	230 V	913713019459	BSNE 250L 300I TS	220 V
913710106942	BSN 70L 300I TS	220 V	913713019559	BSNE 400L 300I TS	220 V

