



Greenspace Flex

RS378B P42 940 PSU-E WB M102

Greenspace Flex, 42 W, 940 neutral white, 32°, Finger-protected

GreenSpace Flex is performance portfolio dedicated to Hospitality segment for GC/GM countries. With modular design concept, the light engines and different trims could have multiply of combination to satisfy diversified customer's requirement.

Product data

General Information	
Number of gear units	1 unit
Driver included	Yes
Light source engine type	LED
CE mark	-
Warranty period	3 years
Flammability mark	-
ENEC mark	-
Glow-wire test	Temperature 600 °C, duration 30 s
EU RoHS compliant	Yes

Light Technical	
Luminous Flux	4242 lumen
Correlated Color Temperature (Nom)	4000 K
Luminous Efficacy (rated) (Nom)	101 lm/W
Color rendering index (CRI)	<gt;/>90
Beam angle of light source	- degree(s)
Light source color	940 neutral white
Optic type	-
Optical cover/lens type	-

Luminaire light beam spread	32°
Operating and Electrical	
Input Voltage	220 to 240 V
Line Frequency	50 or 60 Hz
Average CLO power consumption	3515 W
Power Consumption	42 W
Power Factor (Fraction)	0.9
Connection	External connector
Cable	-
Number of products on MCB of 16 A type B	-

Temperature	
Ambient temperature range	-20 to +45 °C
Controls and Dimming	
Dimmable	No
Driver/power unit/transformer	Electronic transformer
Control interface	-
Constant light output	No

Greenspace Flex

Mechanical and Housing

Housing Material	Aluminum Alloy
Reflector material	-
Optic material	Polymethyl methacrylate
Optical cover/lens material	-
Fixation material	Aluminum
Housing Color	Dark gray
Optical cover/lens finish	-
Overall length	0 mm
Overall width	0 mm
Overall height	116 mm
Overall diameter	102 mm
Dimensions (Height x Width x Depth)	116 x 0 x 0 mm

Approval and Application

Ingress protection code	IP20 [Finger-protected]
Mech. impact protection code	IK04 [0.5 J standard plus]
Protection class IEC	Safety class II

Initial Performance (IEC Compliant)

Initial chromaticity	SDCM<lt/>3
----------------------	------------

Luminous flux tolerance	+/-10%
Power consumption tolerance	+/-10%

Over Time Performance (IEC Compliant)

Median useful life L80B50	50000 hour(s)
---------------------------	---------------

Application Conditions

Maximum dim level	Not applicable
Suitable for random switching	No

Product Data

Full product code	911401721692
Order product name	RS378B P42 940 PSU-E WB M102
Order code	911401721692
Numerator - Quantity Per Pack	1
Numerator - Packs per outer box	12
Material Nr. (12NC)	911401721692
Full product name	RS378B P42 940 PSU-E WB M102

Dimensional drawing

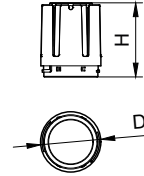
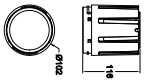

Modular Type	D, mm	H, mm
RS378B P6/P11 M55	55	49
RS378B P15 M55	55	49
RS378B P24 M70	70	90
RS378B P33 M87	87	107
RS378B P42 M102	102	116

