

# PHILIPS

## Lighting



# Electronic semi-parallel ignitor for HID lamp circuits

## SN 56

HID ignitors for semi-parallel systems

### Product data

General information		T-ambient (min.)		-20 °C	
Application code	56	T-Case maximum (max.)		60 °C	
Operating and electrical		Mechanical and housing			
Input Voltage	220 to 240 V	Housing	Akulon S223		
Input frequency	50 to 60 Hz	Approval and application			
Ignition type	Semi-Parallel	Approval marks	CE marking		
Ignition voltage (max.)	5.0 kV	Product data			
Ignition voltage (min.)	2.8 kV	Full product code	697013372885700		
Response voltage	196 V	Order product name	SN 56		
Mains voltage performance (AC)	-8%+6%	EAN/UPC – product	6970133728857		
Mains voltage safety (AC)	-10%+10%	Order code	913710010713		
Power losses (nom.)	1.5 W	SAP numerator – quantity per pack	1		
Wiring		Numerator – packs per outer box	20		
Ballast contact wire cross section	0.50-2.50 mm <sup>2</sup>	SAP material	913710010713		
Connector type	Screw	Net Weight (Piece)	0.079 kg		
Temperature					
T-ambient (max.)	55 °C				

# Electronic semi-parallel ignitor for HID lamp circuits

## Dimensional drawing

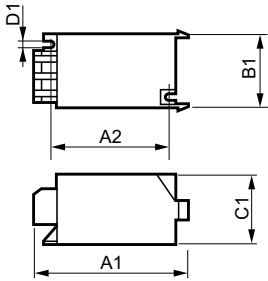

Product	C1	A1	A2	B1
SN 56	38.5 mm	114.5 mm	95.0 mm	41.5 mm

SN 56

